

IDE Drive Case

External 5.25" FireWire IDE CD Drive Case



Installation Manual

IDECASE525F

General Description

The IDECASE525F is designed to connect your IDE devices onto the IEEE 1394 bus. It provides an ideal interconnect for multimedia applications. The IDECASE525F is 10 to 15 times faster than parallel or USB IDE cases and supports full IEEE-1394 FireWire transfer rates of 400Mbits/sec (50Mbytes/sec). CD-ROM, CD-RW and DVD drives can be connected to the IDECASE525F.

Features

- Make any HDD, CD-ROM, DVD, or CD-RW drive portable
- High speed FireWire interface is as fast as an internal drive connection
- Plug and Play portability allows the device to be plugged in as needed and stored out of the way when not needed
- Works with 5.25 inch IDE drives like CD-ROM, CD-RW and DVD
- Works with PC (Windows 98SE, ME, or 2000) or Mac (OS 9 or better)
- High speed 400 Mbps IEEE-1394 FireWire transfer rate
- Power free design - uses power supplied by the FireWire bus
- Provides a daisy chain port for connecting additional FireWire peripherals
- A cooling fan keeps air moving through the case

Getting Started

Unpacking the IDECASE525F

- 1 x IDECASE525F IEEE-1394 Enclosure
- 1 x 6 to 6 pin IEEE 1394 cable
- 1 x External power cable
- 6 x Small screws
- 4 x Medium screws
- 2 x keys

Parts Description

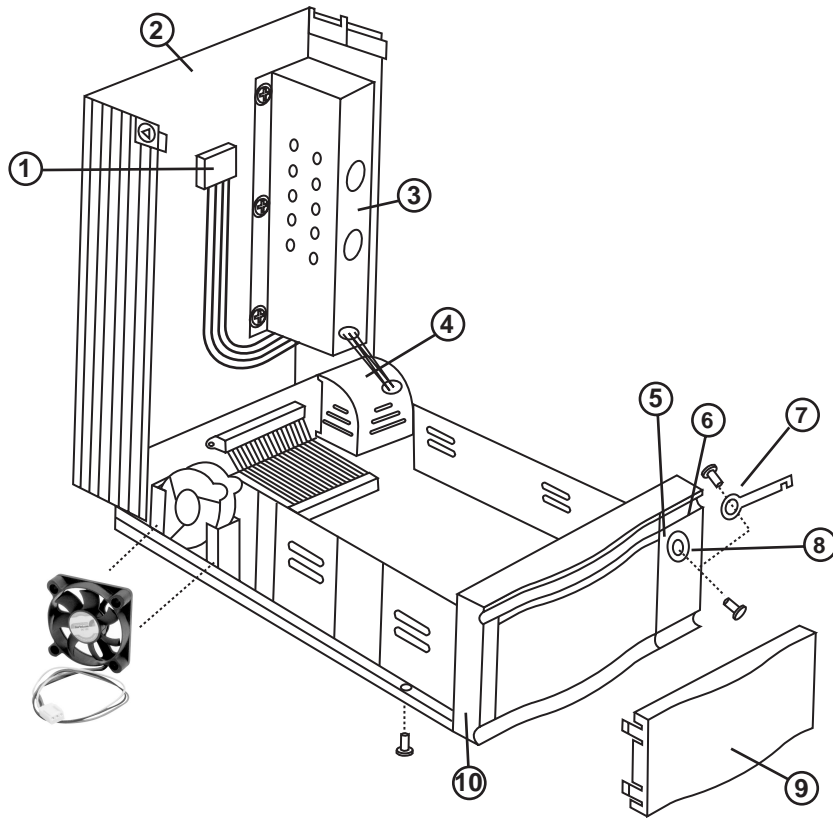

Overview

- | | |
|-----------------------|-----------------------|
| 1) 5V12V power | 6) Power LED |
| 2) Cover | 7) Lock pin |
| 3) Power shield plate | 8) Key lock |
| 4) Wire cover box | 9) Front pane |
| 5) HDD monitoring LED | 10) Front panel frame |

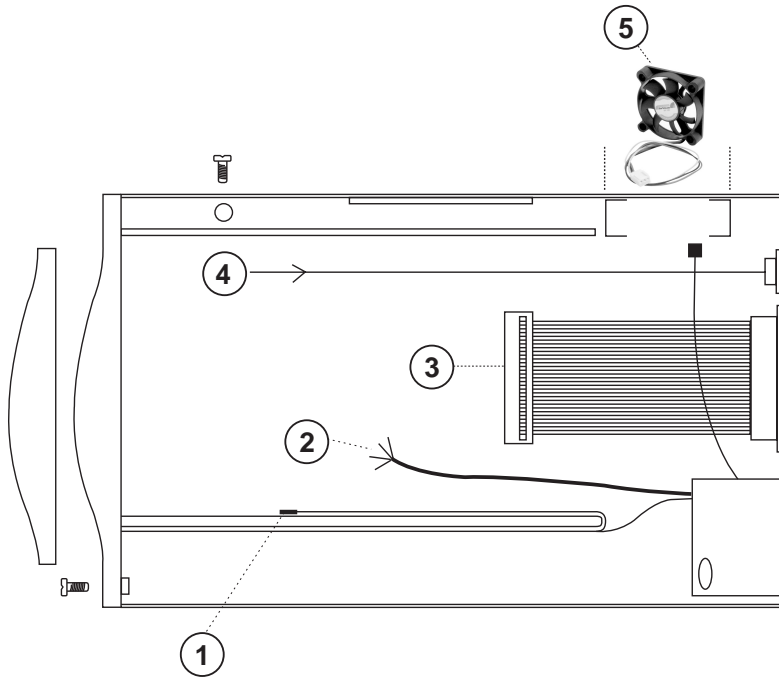

Top View

- 1) Working indicator
- 2) ID switch
- 3) 40-pin cable (IDE)
- 4) Audio output
- 5) Cooling fan

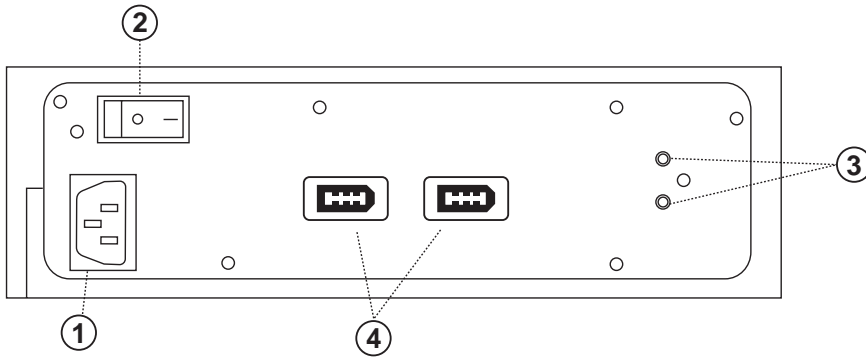

Back View

- 1) Power input
- 2) Power switch
- 3) USB connector
- 4) Audio output (for CD-ROM only)

Installing USB devices into the Drive Case

1. Locate the arrow buttons on both sides of the case. Press the buttons and lift the cover.
2. To install your devices:
 - a) For CD-ROM - Install the CD-ROM and join the connector, power and RCA jack then fasten the enclosed screws on both sides of the interior side panels, securing the device into place.
 - b) For Hard Drive Drawers - Install the Hard Drive Drawer and join the connector & power then fasten the enclosed screws on both sides of the interior side panels, securing the device into place. (To install drive drawers that are 3.5 inches you require an adapter bracket, such as the StarTech.com **BRACKET**)
 - c) **For other devices, read the instructions on your device manual.**
3. Join the connectors with the following descriptions:

HDD LED Out

Color	Yellow	White
Yellow LED	+	-

Audio

Color	Red	White	Black
RCA Jack	Right	Len	COM

Power

Color	Red	Black	Black	Yellow
DC power	+5	COM	COM	+12

4. Close the cover.

Driver Installation

Power on the IDECASE525F. The operating system will recognize the new hardware.

*Note: For HDD - PC Jumper Setting must be set to Master
Mac Jumper Setting must be set to Cable Select*

Windows 98/200/Me/XP

The driver is supplied by the operating system located in "Device Manager", "Storage Device", "IEEE-1394 Disk".

Mac OS

The driver must be downloaded from
www.startech.com/startechframe.asp?target=/downloads/harddisk.htm

1. Select the IDECASE525F driver.
2. Open the Radialogic folder on your desktop.
3. Double click on installer.
4. Follow the on screen prompts.

Limitation of Liability

In no event shall the liability to StarTech.com Ltd. (or its officers, directors, employees or agents) for any damages (whether direct or indirect, special, punitive incidental, consequential, or otherwise), loss of profits, loss of business, or any pecuniary loss, arising out of related to the use of the product exceed the actual price paid for the product.

Some states do not allow the exclusion or limitation of incidental or consequential damages. If such laws apply, the limitations or exclusions contained in this statement may not apply to you.