

P1 — TYPE C

Pin Assignment

| P1 | | type c 符 | |
|---------------------|-------|----------|-------|
| CC | A5 | A5 | A5 |
| DP | A6 | A6 | A6 |
| DN | A7 | A7 | A7 |
| SBU1 | A8 | A8 | A8 |
| Vconn | B5 | B5 | B5 |
| SBU2 | B8 | B8 | B8 |
| SSTXp1 | A2 | A2 | A2 |
| SSTXn1 | A3 | A3 | A3 |
| SSRXp2 | A11 | A11 | A11 |
| SSRXn2 | A10 | A10 | A10 |
| SSTXp2 | B2 | B2 | B2 |
| SSTXn2 | B3 | B3 | B3 |
| SSRXp1 | B11 | B11 | B11 |
| SSRXn1 | B10 | B10 | B10 |
| GND (A1,A12,B1,B12) | Shell | A1 | Shell |
| VBUS (A4,A9,B4,B9) | Shell | A4 | Shell |

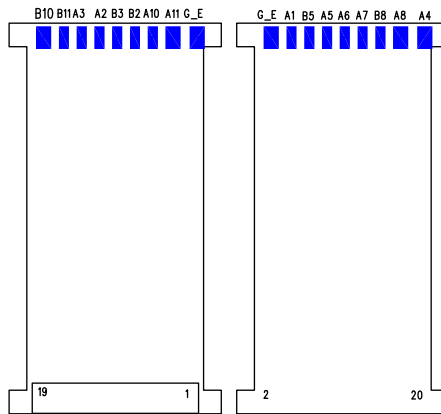

HDMI — P2

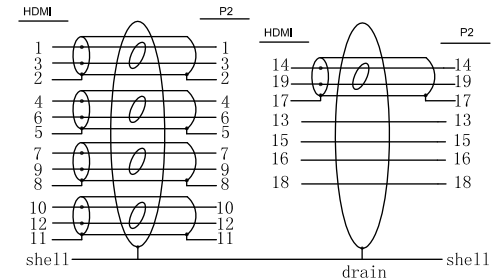

| NO | DESCRIPTION | Q'TY | UNIT |
|----|--|------|------|
| 10 | W=25MM COPPER FOIL | 0.08 | M |
| 9 | HDMI AM DUST CAP | 1 | pcs |
| 8 | 45P Black PVC | 10 | g |
| 7 | UTC-H-5M-NXP epitheca tinplate | 1 | pcs |
| 6 | UTC-H-5M-NXP tinplate hypothea | 1 | pcs |
| 5 | UTC-H-5M-NXP epitheca~ABS~black~no mark | 1 | pcs |
| 4 | UTC-H-5M-NXP hypothea~ABS~black~no mark | 1 | pcs |
| 3 | UTC-H-5M-NXP/UTC-D-5M-NXP | 1 | pcs |
| 2 | USB3.1 Type CM TO OPEN~32AWG~OD:4.8MM~L=0.76M~PVC Jacket color:Black Nickel plated | 1/2 | pcs |
| 1 | HDMI Cable AM TO AM~30AWG~OD:6.0MM~L=3.24M~ PVC Jacket color:Black Nickel plated | 1/2 | pcs |

THIRD ANGLE PROJECTION

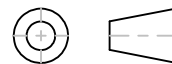

GENERAL NOTES

DIMENSIONS ARE IN MM - DO NOT SCALE
THIS DOCUMENT CONTAINS CONFIDENTIAL, PROPRIETARY INFORMATION THAT IS PROPERTY OF STARTECH.COM



| | |
|--------------|--|
| PRODUCT ID | CDP2HDM2MB |
| DESCRIPTION | USB-C to HDMI Adapter Cable - 2m (6 ft.) - 4K at 30 Hz |
| DO NOT SCALE | SHEET: 1 OF: 1 |
| | UPLOAD DATE: 3/15/2022 |