

PIN Assignment		
TIP	P1 — RED — P2	1
RING	2 — WHITE — 2	2
SLEEVE	3 — YELLOW — 3	3

**ELECTRICAL TESTING:**

- (1) 100% open short & miss wire test.
- (2) Insulation Resistance:  $\geq 5M\Omega$ .
- (3) Contact Resistance:  $5\Omega$ .
- (4) Dielectric Strength: DC 300V/0.1s.
- (5) Connector: Insertion/extraction durability: 5000 cycles minimum
- (6) Swing test: 100g weight, +/-45degrees, 10cycles/minute, 5000 cycles

PART NUMBER	LENGTH (mm)
MU1MMMSWH	1000 ± 30
MU2MMMSWH	2000 ± 30
MU3MMMSWH	3000 ± 50

④	Cover	ABS, Bright White
③	SR	45P PVC, White
②	CONNECTOR	3.5 STEREO MALE, PLATED WITH GOLD, BLACK CORE, FLANGE OD: 5.5
①	CABLE	3C: (7/0.12TC+PP0.55)*3C Red/White/Yellow +PVC Jacket, White OD: 2.2
ITEM	P/N	DESCRIPTION

THIRD ANGLE PROJECTION

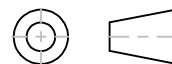

**GENERAL NOTES**

DIMENSIONS ARE IN MM - DO NOT SCALE  
 THIS DOCUMENT CONTAINS CONFIDENTIAL, PROPRIETARY INFORMATION THAT IS PROPERTY OF STARTECH.COM

**StarTech.com**

PRODUCT ID	MUXMMMSWH
DESCRIPTION	White Slim 3.5mm Stereo Audio Cable - Male to Male
<b>DO NOT SCALE</b>	<b>SHEET: 1 OF: 1</b>
<b>UPLOAD DATE: 1/17/2025</b>	