

Bidirectional M.2 NVMe to 2.5"/3.5" SATA Duplicator - USB-C - 10Gbps

Product ID

N2-M2-SSD-DUPPLICATOR

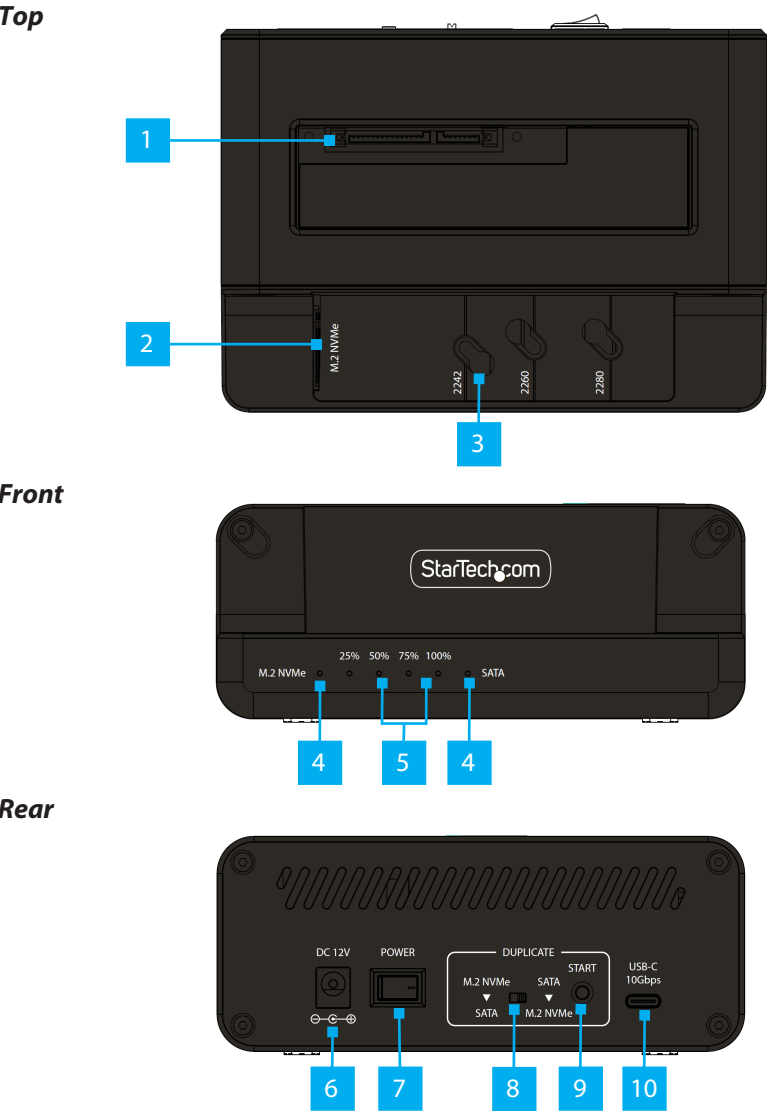

Component		Function
1	SATA Drive Bay	<ul style="list-style-type: none">Insert a 2.5 / 3.5in SATA DriveSupports SATA I/II/III
2	M.2 NVMe Drive Bay	<ul style="list-style-type: none">Insert an M.2 NVMe Drive (M Key)
3	M.2 Mounting Holes	<ul style="list-style-type: none">Secure the M.2 NVMe Drive into position using the included Rubber M.2 Standoff
4	Drive LED Indicators	<ul style="list-style-type: none">Individual LEDs for M.2 NVMe and SATA drive detectionSolid: Drive(s) detectedFlashing: Read/Write activity
5	Progress LED Indicators	<ul style="list-style-type: none">Indicates progress from 25% to 100% during the Duplication process
6	DC Power Input	<ul style="list-style-type: none">Connect the included Universal Power Adapter
7	Power Switch	<ul style="list-style-type: none">Turn the Drive Duplicator On or Off
8	Source Drive Selector Switch	<ul style="list-style-type: none">Select the Source and Target Drive for cloningIf Source Drive is M.2: Select M.2 NVMe -> SATAIf Source Drive is SATA: Select SATA -> M.2 NVMe
9	Clone Button	<ul style="list-style-type: none">Starts the Drive Duplication processSee Operation section for more information
10	USB-C Host Connection	<ul style="list-style-type: none">Connect the M.2 NVMe/SATA Duplicator to an available USB-C Port on a Host Computer<ul style="list-style-type: none">Only required for PC ModeSupports USB 10Gbps

Requirements

For the latest product information, technical specifications, and declarations of conformance, please visit: www.StarTech.com/N2-M2-SSD-DUPPLICATOR

Package Contents

- M.2 NVMe/SATA Duplicator Dock x 1
- USB-C Cable x 1
- Rubber M.2 Standoff x 2
- Power Adapter (NA/JP, UK, EU, ANZ) x 1
- Quick-Start Guide x 1

Installation

Power the Drive Duplicator Dock

1. Connect the **Universal Power Adapter** to the appropriate **Regional Wall Clip**.
2. Connect the **Universal Power Adapter** to the **DC Power Input**, located on the rear of the **M.2 NVMe/SATA Duplicator**.
3. Toggle the **Power Switch**, located on the rear of the **M.2 NVMe/SATA Duplicator**, to the **ON** position.

Note: The M.2 NVMe/SATA Duplicator Dock should be powered off before removing or adding drives to the Drive Bays.

Operation

Warning! M.2 Drives can become hot during duplication or prolonged data transfer sessions. Avoid touching the M.2 Drives immediately after use to prevent burns or damage. Allow the drives to cool down before removing/handling.

Connect to a Computer

1. Insert a 2.5 / 3.5in SATA Drive into the **SATA Drive Bay**.
2. Insert an **M.2 NVMe Drive** horizontally into the **NVMe Drive Bay**.
3. Align the **M.2 Mounting Hole** on the **M.2 NVMe Drive** with the **NVMe Drive Bay**. Secure the **M.2 NVMe Drive** into position using the included **Rubber Stopper**.
4. Connect the included **USB-C Cable** from the **USB-C Port**, located on the rear of the **Drive Duplicator Dock**, to an available **USB-C Port** on the **Host Computer**.
5. The **Host Computer** will automatically detect and install the required **Drivers**.

Regulatory Compliance

FCC Compliance Statement
This equipment has been tested and found to comply with the limits for a Class B digital device, pursuant to Part 15 of the FCC Rules. These limits are designed to provide reasonable protection against harmful interference in a residential installation. This equipment generates, uses, and can radiate radio frequency energy and, if not installed and used in accordance with the instructions, may cause harmful interference to radio communications. However, there is no guarantee that interference will not occur in a particular installation. If this equipment does cause harmful interference to radio or television reception, which can be determined by turning the equipment off and on, the user is encouraged to try to correct the interference by one or more of the following measures:

- Reorient or relocate the receiving antenna.
 - Increase the separation between the equipment and receiver.
 - Connect the equipment to an outlet on a different circuit than the receiver.
 - Consult the dealer or an experienced radio/TV technician for help.
- Any changes or modifications not expressly approved by the party responsible for compliance could void the user's authority to operate the device. If shielded interface cables are included with the product, or if additional components or accessories are designated for use with the installation, they must be used to ensure compliance with FCC regulations.

ISED Statement / Déclaration d'ISDE

CAN ICES-003(B) / NMB-003(B)

This Class B digital apparatus complies with Canadian ICES-003. This device complies with ISED Canada licence-exempt RSS standard(s). Operation is subject to the following two conditions: (1) this device must not cause interference, and (2) this device must accept any interference, including interference that may cause undesired operation of the device.

Cet appareil numérique de la classe B est conforme à la norme NMB-003 du Canada. Le présent appareil est conforme aux CNR d'ISDE Canada applicables aux appareils radio exempts de licence. L'exploitation est autorisée aux deux conditions suivantes : (1) l'appareil ne doit pas produire de brouillage, et (2) l'appareil doit accepter tout brouillage radioélectrique subi, même si le brouillage est susceptible d'en compromettre le fonctionnement.

Clone a Drive

1. Ensure that the **Source Drive Selector Switch**, located on the rear of the **M.2 NVMe/SATA Duplicator**, is set correctly.

Note: If the cloning direction is set incorrectly, the hard disk originally intended to be the source will become the target disk, and the data will be lost

If the Source Drive is **M.2 NVMe**: Select **M.2 NVMe -> SATA**

If the Source Drive is **SATA**: Select **SATA -> M.2 NVMe**

2. Insert the **M.2 NVMe Drive** and **SATA Drive** into the **Drive Bays**.
3. Toggle the **Power Switch**, located on the rear of the **M.2 NVMe/SATA Duplicator**, to the **ON** position.
4. Press and Hold the **Clone Button** until the **Progress LED Indicators** begin to flash. Immediately release and press the **Clone Button** once more. The **25% LED** will begin to flash to indicate the duplication process is in progress.

Warning! Do not disconnect either drive or interrupt the process until the duplication process has completed. Doing so may result in damage to the drive or lost data.

Note: As each 25% segment of the duplication process finishes, the corresponding LED will turn solid, while the subsequent LED will begin to flash

5. When **All Progress LED Indicators** are no longer flashing and have become solid, the duplication process is complete.

Note: If the M.2 NVMe/SATA Duplicator encounters an error, please check the LED Indicator status

Status	LED Behavior
Drive disconnected during cloning	<ul style="list-style-type: none">• Drive LEDs: Disconnected drive LED flashing slowly• Progress LEDs: Illuminated LEDs flashing slowly
Source Drive is larger than Target Drive	<ul style="list-style-type: none">• Drive LEDs: LEDs are not illuminated• Progress LEDs: All LEDs are flashing alternately

Warranty Information

This product is backed by a two-year warranty. For further information on product warranty terms and conditions, please refer to www.startech.com/warranty.

Limitation of Liability

In no event shall the liability of StarTech.com Ltd. and StarTech.com USA LLP (or their officers, directors, employees or agents) for any damages (whether direct or indirect, special, punitive, incidental, consequential, or otherwise), loss of profits, loss of business, or any pecuniary loss, arising out of or related to the use of the product exceed the actual price paid for the product. Some states do not allow the exclusion or limitation of incidental or consequential damages. If such laws apply, the limitations or exclusions contained in this statement may not apply to you.

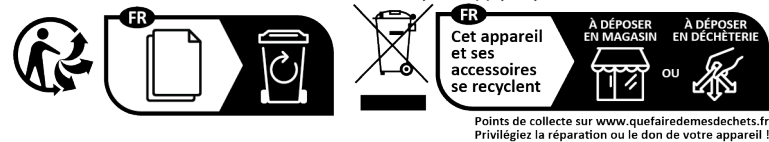

StarTech.com Ltd. 45 Artisans Cres London, Ontario N5V 5E9 Canada	StarTech.com LLP 4490 South Hamilton Road Groveport, Ohio 43125 U.S.A.	StarTech.com Ltd. Unit B, Pinnacle 15 Gowerton Rd, Brackmills Northampton NN4 7BW United Kingdom	StarTech.com Ltd. Siriusdreef 17-27 2132 WT Hoofddorp The Netherlands	FR: startech.com/fr DE: startech.com/de ES: startech.com/es NL: startech.com/nl IT: startech.com/it JP: startech.com/jp
--	---	---	---	--