

LENGTH (see table)

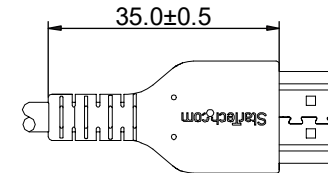
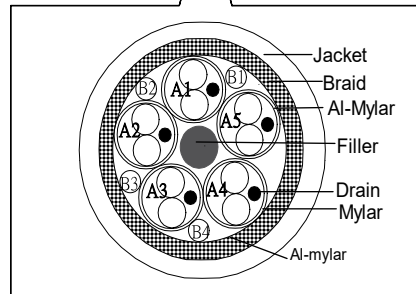
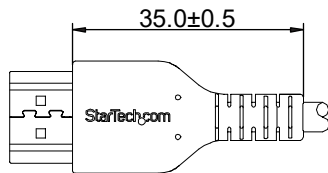
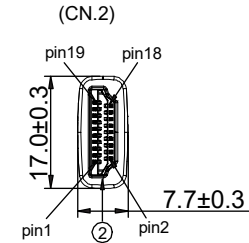
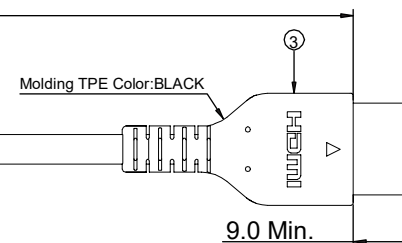

Wire Pin Assignment and Wire Description.

CN.1	Signal Assignment	CN.2	WIRE
1	TMDS Data2+	1	WHITE
2	TMDS Data2 Shield	2	DRAIN
3	TMDS Data2-	3	GREEN
4	TMDS Data1+	4	WHITE
5	TMDS Data1 Shield	5	DRAIN
6	TMDS Data1-	6	ORANGE
7	TMDS Data0+	7	WHITE
8	TMDS Data0 Shield	8	DRAIN
9	TMDS Data0-	9	BROWN
10	TMDS Clock+	10	WHITE
11	TMDS Clock Shield	11	DRAIN
12	TMDS Clock-	12	BLUE
14	Utility/HEAC+	14	WHITE
17	DDC/CEC Ground	17	DRAIN
19	Hot Plug Detect	19	YELLOW
13	CEC	13	PURPLE
15	SCL	15	BLUE
16	SDA	16	GREEN
18	+5V Power	18	RED
SHELL		SHELL	BRAID

Part NO.(White)	Part NO.(Black)	Length
RHDMM1MPW	RHDMM1MP	1000±30
RHDMM2MPW	RHDMM2MP	2000±50

③	TPE Molded	/
②	HDMI CONNECTOR HOUSING BLACK TER: (GOLD PLATED CONTACTS,GOLD PLATED SHELL.)	2PCS
①	PREMIUM HDMI CABLE[(34AWG*2C+EAM)*5P+34AWG*4C]+MB BARE COPPER-B:85% OD:4.5mm Jacket TPE	/
ITEM	MATERIALS LIST & SPEC. DESCRIPTION	Q'TY

THIRD ANGLE PROJECTION

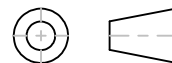

GENERAL NOTES

DIMENSIONS ARE IN MM - DO NOT SCALE
THIS DOCUMENT CONTAINS CONFIDENTIAL,
PROPRIETARY INFORMATION THAT IS
PROPERTY OF STARTECH.COM

StarTech.com

PRODUCT ID	RHDMMxMPy		
DESCRIPTION	HDMI 2.0 PREMIUM CERTIFIED TPE CABLE		
DO NOT SCALE	SHEET: 1 OF: 1	UPLOAD DATE: 4/20/2023	