

THIRD ANGLE PROJECTION

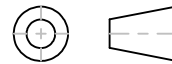

GENERAL NOTES

DIMENSIONS ARE IN MM - DO NOT SCALE
 THIS DOCUMENT CONTAINS CONFIDENTIAL,
 PROPRIETARY INFORMATION THAT IS
 PROPERTY OF STARTECH.COM

StarTech.com

PRODUCT ID	UNISLDSHF192
DESCRIPTION	2U Vented Sliding Server Rack Shelf w/ Cable Management Arm - 27.7 to 31.6in Adjustable Mounting Depth - 50lb - 19" Server Tray Shelf for Equipment Rack - 24in Deep
DO NOT SCALE	SHEET: 1 OF: 1
UPLOAD DATE: 1/24/2022	