

WIRE LIST

P1 USB Type-C Plug		Cable	P2 HDMI PCBA	
Pin	Signal Name	Wire Color	Pin	Pin
B12	GND	DRAIN	1	1
B10	SSRXn1	WHITE	2	2
B11	SSRXp1	BLACK	3	3
A1	GND	DRAIN	4	4
A3	SSTXn1	WHITE	5	5
A2	SSTXp1	RED	6	6
B1	GND	DRAIN	7	7
B3	SSTXn2	WHITE	8	8
B2	SSTXp2	BLUE	9	9
A12	GND	DRAIN	10	10
A10	SSRXn2	WHITE	11	11
A11	SSRXp2	ORANGE	12	12
B8	SBU2	YELLOW	13	13
A8	SBU1	PURPLE	14	14
A5	CC	RED	17	17
A6	Dp1	GREEN	15	15
A7	Dn1	WHITE	16	16
B5	Vconn	BLUE	18	18
A4,B4,A9,B9	Vbus	BLACK	19	19
Shell	Shield	Shield	20,21,Shell	20,21,Shell

NOTES:

1. ALL MATERIALS ARE RoHS COMPLIANT;
2. Cable assembly to be 100% tested for opens, shorts, miswires ;
3. Video Test Every Production;
4. EMI to mated pair: Compliant to FCC Part 15 Class B;
5. ESD to mated pair: Compliant to IEC 61000-4-2 (Level 4 HBM capability for 8kV for direct discharge and 15kV for air discharge);
6. Logo color : "StarTech" and HDNI white, "•"pantone 123C, "•"pantone Cool gray 9C

THIRD ANGLE PROJECTION

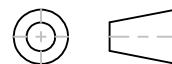

GENERAL NOTES

DIMENSIONS ARE IN MM - DO NOT SCALE
THIS DOCUMENT CONTAINS CONFIDENTIAL, PROPRIETARY INFORMATION THAT IS PROPERTY OF STARTECH.COM

StarTech.com

PRODUCT ID	CDP2HD
DESCRIPTION	USB-C to HDMI Adapter with 4K 30Hz - Black
DO NOT SCALE	SHEET: 1 OF: 1
	UPLOAD DATE: 1/6/2021

No	NAME	DESCRIPTION	Q'TY	UNIT
5	PCBA	USB C TO HDMI1.4 PCBA,CONN,HDMI A 19P,F,SOLDER,15U"Au,BLK,LCP,SHELL NI	1	SET
4	SHELL	SLIM HDMI SHELL: PLASTIC COVER(CASE+COVER)	1	SET
3	SHELL	SLIM HDMI SHELL: STEEL(UPPER+BOTTOM)	1	SET
2	CONN	CONN,USB C 22P,MALE,15U"Au,BLK,SHELL NI,USB3.0 C TYPE,PCBA,	1	SET
1	CABLE	CBL,UL21100,(34#*2C+EMA)*4+(34#*2C+AM)*2+34#*1P+30#*1C+FAB,BK001,OD4.1,KS	AR	M