

(A).Wire Pin Assignment and Wire Description.

CN.1	PAIR#	CN.2	COLOR	
1	PAIR1	12	BLUE	red mylar
3		10	WHITE	
2		11	DRAIN	
4	PAIR2	9	BLUE	yellow mylar
6		7	WHITE	
5		8	DRAIN	
7	PAIR3	6	BLUE	orange mylar
9		4	WHITE	
8		5	DRAIN	
10	PAIR4	3	BLUE	blue mylar
12		1	WHITE	
11		2	DRAIN	
13	SIGNAL	13	GREEN	
14	SIGNAL	14	RED	
15	PAIR5	15	BLUE	green mylar
17		17	WHITE	
16		16	DRAIN	
18	SIGNAL	18	PURPLE	
19	SIGNAL	19	BLUE	
SHELL		SHELL	BRAID	

(B). Electrical Testing :

- OPEN/SHORT:100% Testing Line-Process.
- HI-POT: 100V AC/0.1sec.
- INSULATION RESISTANCE:10MΩ(MIN) 100V DC
- CONDUCTION RESISTANCE:3Ω(MAX)

THIRD ANGLE PROJECTION

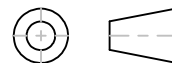

GENERAL NOTES

DIMENSIONS ARE IN MM - DO NOT SCALE  
THIS DOCUMENT CONTAINS CONFIDENTIAL, PROPRIETARY INFORMATION THAT IS PROPERTY OF STARTECH.COM

**StarTech.com**

PRODUCT ID	DP14MM2M
DESCRIPTION	2M DISPLAYPORT 1.4 CABLE
<b>DO NOT SCALE</b>	<b>SHEET: 1 OF: 1</b>
	<b>UPLOAD DATE: 10/13/2020</b>

ITEM	MATERIALS LIST & SPEC. DESCRIPTION	Q'TY
④	MOLDING:PVC BLACK	/
③	DISPLAYPORT TOP/LOWER CASING:PC BLACK	1
②	DISPLAYPORT 20PIN PLUG,TERMINAL Au-PLATED SHELL Au-PLATED	1
①	DP CABLE [(34AWGx2C+EAM)x5P+34AWGx4C]+AB OD:4.5 Braid:85% BLACK PVC	/