

CONNECTION

DP JACK	PAIR#	PIN NAME	COLOR	DP PLUG
1	PAIR1 BLUE	ML_Lane 0(p)	BLUE	1
2		GND	DRAIN	2
3		ML_Lane 0(n)	WHITE	3
4	PAIR2 BROWN	ML_Lane 1(p)	BLUE	4
5		GND	DRAIN	5
6		ML_Lane 1(n)	WHITE	6
7	PAIR3 RED	ML_Lane 2(p)	BLUE	7
8		GND	DRAIN	8
9		ML_Lane 2(n)	WHITE	9
10	PAIR4 YELLOW	ML_Lane 3(p)	BLUE	10
11		GND	DRAIN	11
12		ML_Lane 3(n)	WHITE	12
13		CONFIG 1	BROWN	13
14		CONFIG 2	ORANGE	14
15	PAIR5 GREEN	AUX_CH(p)	BLUE	15
16		GND	DRAIN	16
17		AUX_CH(n)	WHITE	17
18		Hot plug Detect	YELLOW	18
19		Return_DP PWR	BLUE	19
20		DP_PWR	RED	20
SHELL	GND	Braid(GND)	GND	SHELL

ITEM	DESCRIPTIONS	Q'TY
11	PVC MOLDING STRAIN RELIEF,COLOR:BLACK	1
10	LD PE MOLDING INTERNAL MODEL,COLOR:CLEAR	1
9	NUT,#4-40UNC,MATERIAL:12L14,NI PLATED	2
8	SCREW,#4-40UNC,MATERIAL:C1018,NI PLATED	2
7	METAL BOTTOM SHELL, USED FOR DP CONNECTOR	1
6	METAL TOP SHELL, USED FOR DP CONNECTOR	1
5	ABS BOTTOM SHELL,USED FOR DP CONNECTOR,COLOR:BLACK	1
4	ABS TOP SHELL,USED FOR DP CONNECTOR,COLOR:BLACK	1
3	DP 20P FEMALE CONNTECTOR,TERMINALS GOLD PLATED,METAL SHELL NI PLATED,INSULATOR COLOR:BLACK	1
2	DP 20P MALE CONNTECTOR,TERMINALS GOLD PLATED,METAL SHELL NI PLATED,INSULATOR COLOR:BLACK	1
1	DP CABLE,(28AWG*1P+AEM)*5+28AWG*5C+F+AEB,PVC JACKET,COLOR:BLACK	1

ELECTRIC TESTING:
 1.100% OPEN & SHORT TESTING
 2.INSULATION RESISTANCE: ≥ 20MΩ
 3.CONDUCTOR RESISTANCE: ≤ 1.5Ω
 4.VOLTAGE: 300V DC/0.1S

THIRD ANGLE PROJECTION

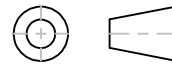

GENERAL NOTES

DIMENSIONS ARE IN MM - DO NOT SCALE
 THIS DOCUMENT CONTAINS CONFIDENTIAL, PROPRIETARY INFORMATION THAT IS PROPERTY OF STARTECH.COM

StarTech.com

PRODUCT ID	DPPNLFM3PW		
DESCRIPTION	3 ft 20 pin DisplayPort Extension Panel Mount Cable - M/F		
DO NOT SCALE	SHEET: 1 OF: 1	UPLOAD DATE: 11/18/2020	