

PCI Expansion Bay

PCI Express to Four Slot PCI Expansion Bay

PEX2PCI4

Instruction Manual



Actual product may vary from photo

StarTech.com
Making hard-to-find easy!

FCC Compliance Statement

This equipment has been tested and found to comply with the limits for a Class B digital device, pursuant to part 15 of the FCC Rules. These limits are designed to provide reasonable protection against harmful interference in a residential installation. This equipment generates, uses and can radiate radio frequency energy and, if not installed and used in accordance with the instructions, may cause harmful interference to radio communications. However, there is no guarantee that interference will not occur in a particular installation. If this equipment does cause harmful interference to radio or television reception, which can be determined by turning the equipment off and on, the user is encouraged to try to correct the interference by one or more of the following measures:

- Reorient or relocate the receiving antenna.
- Increase the separation between the equipment and receiver.
- Connect the equipment into an outlet on a circuit different from that to which the receiver is connected.
- Consult the dealer or an experienced radio/TV technician for help.

Use of Trademarks, Registered Trademarks, and other Protected Names and Symbols

This manual may make reference to trademarks, registered trademarks, and other protected names and/or symbols of third-party companies not related in any way to StarTech.com. Where they occur these references are for illustrative purposes only and do not represent an endorsement of a product or service by StarTech.com, or an endorsement of the product(s) to which this manual applies by the third-party company in question. Regardless of any direct acknowledgement elsewhere in the body of this document, StarTech.com hereby acknowledges that all trademarks, registered trademarks, service marks, and other protected names and/or symbols contained in this manual and related documents are the property of their respective holders.

Table of Contents

Introduction	1
Features	1
Before You Begin	1
System Requirements	1
Package Contents	1
Installation and usage	2
Windows® 2000 / XP Driver Installation	2
Windows® NT Driver Installation	2
Windows® 98SE/ME Driver Installation	3
Troubleshooting	4
Accessory Products from StarTech.com	5
Technical Support	6
Warranty Information	6

Introduction

Thank you for purchasing a StarTech.com PCI Express to Four Slot PCI Expansion Bay. This product allows you to add PCI expandability to your computer, using an available PCI Express slot, helping to bridge the gap between older PCI expansion cards and motherboards with newer interface capabilities.

Features

- Supports 1x 2.5Gb/s PCI Express Data Transfer Rates
- PCI Slots are fully PCI Bus Rev. 2.3 Compliant
- Supports both 5V and 3.3V Add-in Cards
- Supports Windows 2000/2003/XP/ Vista/Linux/Mac OS X and up

Before You Begin

System Requirements

- One available PCI Express slot
- Operating System: Windows 2000/2003/XP/ Vista/Linux/Mac OS X and up

Package Contents

This package should contain:

- 1 x PCI Expansion Bay
- 1 x PCI Express Card
- 1 x DVI Cable
- 1 x Power Adapter
- 1 x Instruction Manual
- 1 x Driver CD
- 1 x Screw Kit

Installation



WARNING: PEX2PCI4 uses a DVI interface to connect the the PCI Express and PCI components. When connecting the PCI expansion board to the PCI Express card, please ensure that the DVI port provided by PEX2PCI4 is not confused with a DVI port provided by the computer video card, as this could damage the video card, as well as the PCI Express expansion card and PCI expansion slot board.

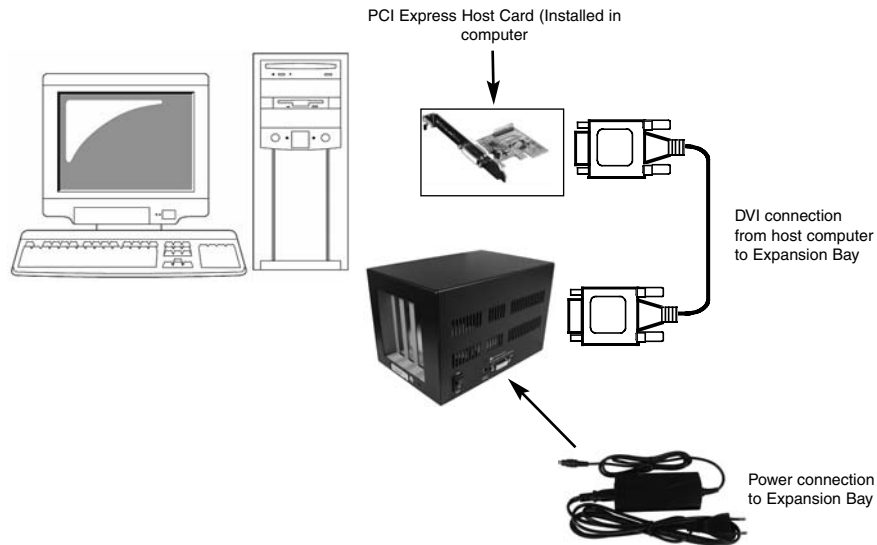

Installing the PCI Express expansion card

1. Turn **OFF** the computer power before installation.
2. Remove the chassis cover from your computer.
3. Locate an unused PCI Express slot and remove the corresponding slot cover from rear panel of the computer chassis. Retain the screw (if applicable) used to hold the slot cover in place.
4. Align the PCI Express card with the unused PCI Express expansion slot. Applying pressure evenly across the top edge of the expansion card, firmly but gently insert the card into the slot, ensuring that the card is properly aligned with the rear panel slot.
5. Secure the card to the motherboard and rear chassis, using the screw removed in step 3.
6. Replace the chassis cover (removed in step 2).

7. Connect the included DVI cable to the DVI port provided by the newly installed PCI Express card. Attach the remaining DVI connector provided by the cable to the PCI Expansion Bay DVI port. **NOTE: When performing this step, please ensure that the DVI port provided by the PCI Express expansion card is not confused with a DVI port provided by the computer video card, as this could damage the video card, as well as the PCI Express expansion card and PCI expansion slot board.**

Installing PCI cards in the expansion bay

1. Open the top cover of the Expansion Bay by removing the screws on the top and side panel.
2. Locate an unused PCI slot and remove the corresponding slot cover from the side panel of the Expansion Bay, by removing the screws used to hold it in place.
3. Align the PCI card with the unused PCI expansion slot. Applying pressure evenly across the top edge of the expansion card, firmly but gently insert the card into the slot, ensuring that the card is properly aligned with the side panel slot. Secure the PCI card to the slot, using the screw removed in step 2.
4. Repeat steps 2 and 3 for the remaining PCI cards you wish to install.
5. Replace the top cover of the Expansion Bay, using the screws that were removed in step 1.
6. a) Insert the cylindrical metal connector provided by the power adapter into the power port (marked +12V DC) on the rear panel of the Expansion Bay.
b) Attach the power adapter cable to the power adapter by inserting the double-cylindrical (plastic) connector to the appropriate port provided by the power adapter.
c) Connect the power adapter to an available power outlet.
7. Since both the PC system and the Expansion Bay are self-powered, you need to follow the correct ON/OFF sequence as follows:

Power On Sequence: Power on the Expansion Bay first, then power on your PC system.

Power Off Sequence: Power off your PC system, then the Expansion Bay

Software Installation

To install the ExpressBooster software supplied with your card:

1. Locate the **setup.exe** file found on the driver CD. Assuming that **E:** is the designation for your CD/DVD-ROM drive, double click on **E:\Utility\ExpressBooster** to launch the setup program.

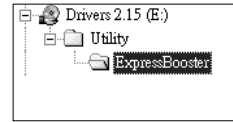

2. Follow the setup on-screen instructions; ensure that there is a checkmark next to **PCI Express Card for Desktops/Servers** only (leave the "Express Card" item un-checked). Proceed with any further on-screen instructions to complete the installation.



Accessory Products from StarTech.com

Contact your local StarTech.com dealer or visit www.startech.com for cables or other accessories that will help you get the best performance out of your new product.



DVIDSMM10
10 ft. DVI-D Single Link Display Cable



DVIDSMM15
15 ft. DVI-D Single Link Display Cable



DVIDSMM20
20 ft. DVI-D Single Link Display Cable



PCI2S950DV
2 Port PCI 16950 RS-232 Dual Voltage / Dual Profile Serial Card



PCI1S950DV
2 Port PCI 16950 RS-232 Dual Voltage / Dual Profile Serial Card

Specifications

Bus Type	PCI
Connectors	PCI Expansion Box: 1 x DVI D (dual link) Female Connector PCI Express Card: 1 x DVI D (dual link) female connector
Form Factor	PCI Express (x1)
Power Adapter	1 x 12V DC, 3 Amp
OS Support	Windows 2000/2003/XP/ Vista/Linux/Mac OS X and up
Regulatory Certifications	CE, FCC, ROHS

Technical Support

StarTech.com's lifetime technical support is an integral part of our commitment to provide industry-leading solutions. If you ever need help with your product, visit www.startech.com/support and access our comprehensive selection of online tools, documentation, and downloads.

Warranty Information

This product is backed by a one year warranty. In addition, StarTech.com warrants its products against defects in materials and workmanship for the periods noted, following the initial date of purchase. During this period, the products may be returned for repair, or replacement with equivalent products at our discretion. The warranty covers parts and labor costs only. StarTech.com does not warrant its products from defects or damages arising from misuse, abuse, alteration, or normal wear and tear.

Limitation of Liability

In no event shall the liability of StarTech.com Ltd. and StarTech.com USA LLP (or their officers, directors, employees or agents) for any damages (whether direct or indirect, special, punitive, incidental, consequential, or otherwise), loss of profits, loss of business, or any pecuniary loss, arising out of or related to the use of the product exceed the actual price paid for the product. Some states do not allow the exclusion or limitation of incidental or consequential damages. If such laws apply, the limitations or exclusions contained in this statement may not apply to you.

About StarTech.com

StarTech.com is “The Professionals’ Source for Hard-to-Find Computer Parts”. Since 1985, we have been providing IT professionals with the quality products they need to complete their solutions. We offer an unmatched selection of computer parts, cables, server management solutions and A/V products and serve a worldwide market through our locations in the United States, Canada, the United Kingdom and Taiwan.

Visit **www.startech.com** for complete information about all our products and to access exclusive interactive tools such as the Parts Finder and the KVM Reference Guide. StarTech.com makes it easy to complete almost any IT solution. Find out for yourself why our products lead the industry in performance, support, and value.