

LENGTH (xx)

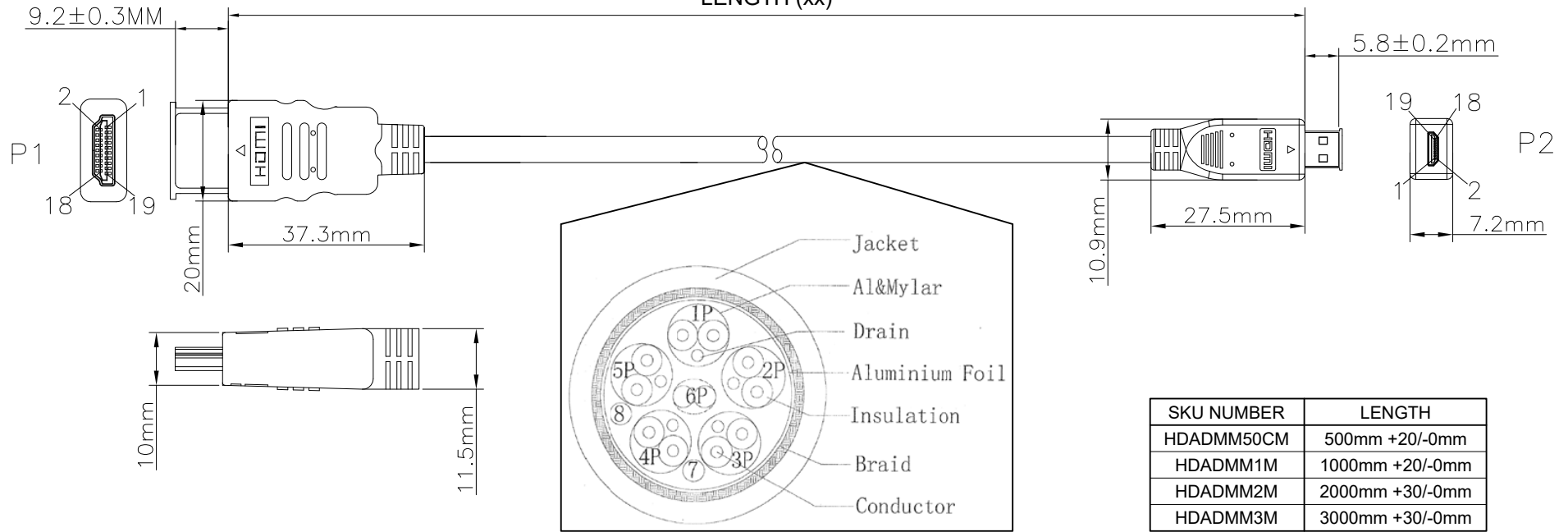

PIN Assignment

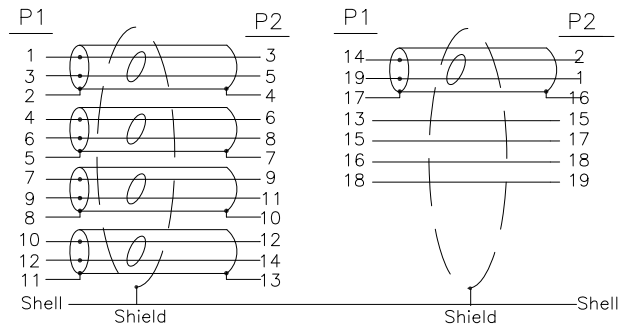

Electrical Test:  
 1.100%Test(Open ,short ,miss wire)  
 2.Contact Resistance: 3 ohm max.  
 3.Insulation Resistance: 10M ohm Min.300V DC/10ms.

9	HDMI DM~Boarding Cap	1	pcs
8	HDMI AM~Boarding Cap	1	pcs
7	HDMI D TYPE 19P M~34AWG~Clamp	1	pcs
6	HDMI A TYPE 19P M~34AWG~Clamp	1	pcs
5	45P Black PVC	16	g
4	Low pressure mold material	3	g
3	HDMI D TYPE 19P M~Sell Gold plated~Pin Gold plated	1	pcs
2	HDMI AM 19P~Sell Gold plated~Insulator Black~Pin Gold plated	1	pcs
1	UL20276 (34AWG*1P+EAM)*5C+32AWG*1P+32AWG*2C+AB 16/10/0.08 TC~Black~OD4.2MM~Marking:High Speed HDMI...	0.52	m
NO	DESCRIPTION	Q'TY	UNIT

THIRD ANGLE PROJECTION

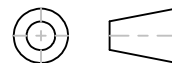

GENERAL NOTES

DIMENSIONS ARE IN MM - DO NOT SCALE  
 THIS DOCUMENT CONTAINS CONFIDENTIAL, PROPRIETARY INFORMATION THAT IS PROPERTY OF STARTECH.COM

StarTech.com

PRODUCT ID	HDADMMxx
DESCRIPTION	High Speed HDMI Cable with Ethernet - HDMI to HDMI Micro - M/M
DO NOT SCALE	SHEET: 1 OF: 1
UPLOAD DATE:	11/26/2020