

(A). Wire Pin Assignment and Wire Description:

CN.1	Signal Assignment	CN.2	WIRE
1	TMDS Data2+	1	WHITE
2	TMDS Data2 Shield	2	DRAIN
3	TMDS Data2-	3	GREEN
4	TMDS Data1+	4	WHITE
5	TMDS Data1 Shield	5	DRAIN
6	TMDS Data1-	6	ORANGE
7	TMDS Data0+	7	WHITE
8	TMDS Data0 Shield	8	DRAIN
9	TMDS Data0-	9	RED
10	TMDS Clock+	10	WHITE
11	TMDS Clock Shield	11	DRAIN
12	TMDS Clock-	12	BLUE
14	Utility/HEAC+	14	WHITE
17	DDC/CEC Ground/HEAC Shield	17	DRAIN
19	Hot Plug Detect/HEAC-	19	YELLOW
13	CEC	13	PURPLE
15	SCL	15	BLUE
16	SDA	16	GREEN
18	+5V Power	18	RED
SHELL		SHELL	BRAID

(B). Electrical Testing :

- a. Open/Short:100%. Testing Line-Process.
- b. HI-POT: 100V AC/0.1sec.
- c. Insulation Resistance: 10MΩ (MIN) 300V DC
- d. Conductive Resistance: 5Ω (MAX)(<5M)  
10Ω (MAX)(5M-15M)

Length table:

Part NO.(F)	Length(L)
HDMM20	6090±100
HDMM25	7620±100
HDMM30	9140±100
HDMM35	10660±100
HDMM45	13710±150
HDMM50	15240±150
HDMM7M	7000±100
HDMM10M	10000±100
HDMM15M	15000±150

③	MOLDED Color: Black PVC	/
②	HDMI A MALE19 PIN CONNECTOR. (GOLD PLATED CONTACTS, GOLD PLATED SHELL.)	2SET
①	HDMI CABLE: [(24AWG*2C+EAM)*4P+(28AWG*2C+EAM)+(28AWG*4C)]+AB, OD:10.0mm Copper Braid:65% Jacket Color: Black PVC	/
ITEM	MATERIALS LIST & SPEC. DESCRIPTION	Q'TY

THIRD ANGLE PROJECTION

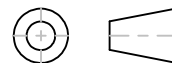

GENERAL NOTES

DIMENSIONS ARE IN MM - DO NOT SCALE  
THIS DOCUMENT CONTAINS CONFIDENTIAL, PROPRIETARY INFORMATION THAT IS PROPERTY OF STARTECH.COM

StarTech.com

PRODUCT ID	HDMM20-50
DESCRIPTION	High Speed HDMI Cable – Ultra HD 4k x 2k HDMI Cable – HDMI to HDMI M/M
DO NOT SCALE	SHEET: 1 OF: 1
	UPLOAD DATE: 12/9/2020