

# StarTech.com®

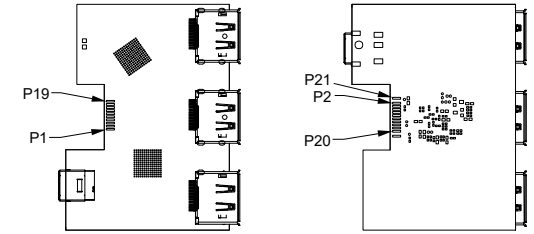
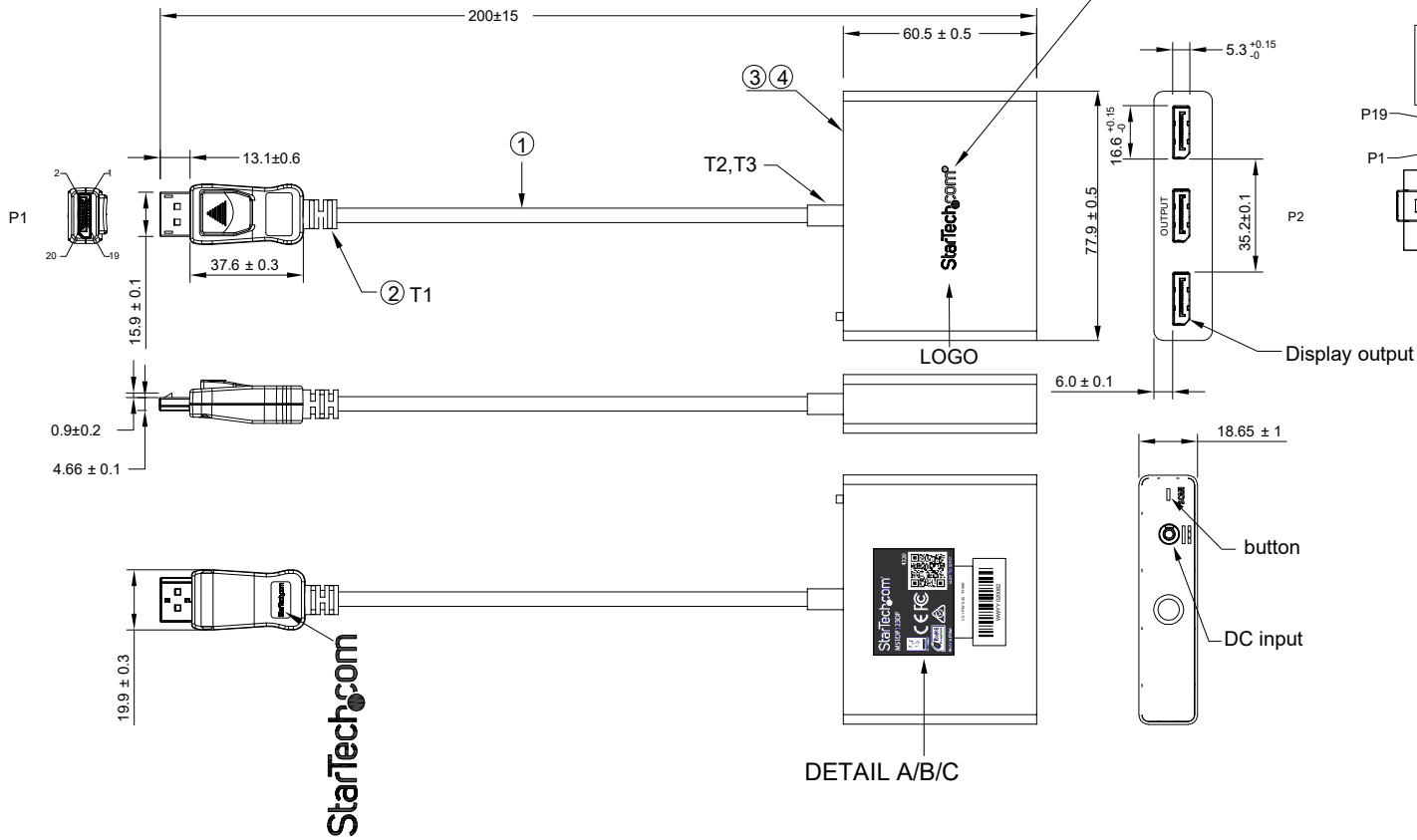

PCBA PIN define

1		WHITE	12
2	PAIR1	DRAIN	11
3		RED	10
4		WHITE	9
5	PAIR2	DRAIN	8
6		BLUE	7
7		WHITE	6
8	PAIR3	DRAIN	5
9		GREEN	4
10		WHITE	3
11	PAIR4	DRAIN	2
12		ORANGE	1
13	CONFIG	YELLOW	13
14	CONFIG	ORANGE	14
15		WHITE	15
16	PAIR5	DRAIN	16
17		BLACK	17
18	HPD	RED	18
19	GND	BLACK	19
	SHELL	GND	21
		BRAID	SHELL
	P1	Wire Color	P2
		Wire List	

- NOTES:
1. ALL MATERIALS ARE RoHS COMPLIANT.
  2. Electrical Performance:
    1. DP Connector Impedance:  $100 \pm 10\Omega$
    2. Cable Impedance:  $100 \pm 5\Omega$
    3. Video Test Every Production.
  3. StarTech Logo color
    - \*StarTech is white
    - \*O is PANTONE 123C
    - \*com is PANTONE Cool gray 9C

4	SHELL	DP1.2 HUB SHELL	1	SET
3	PCBA	PCBA,ST DP1.2 TO HUB1-3 VER2. 1 HF STDP4320	1	SET
2	CONN	DisplayPort CONNECTOR GOLD-PLATED SHELL PLATED NICKEL	1	SET
1	CABLE	UL21100(34#*1P+EAM)*5+32#*2C+30#*2C+FAB,BK001,OD4.4	AR	M
No	NAME	DESCRIPTION	Q'TY	UNIT

THIRD ANGLE PROJECTION

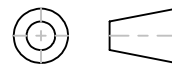

**GENERAL NOTES**

DIMENSIONS ARE IN MM - DO NOT SCALE  
 THIS DOCUMENT CONTAINS CONFIDENTIAL, PROPRIETARY INFORMATION THAT IS PROPERTY OF STARTECH.COM

# StarTech.com

PRODUCT ID	MSTDP123DP		
DESCRIPTION	DisplayPort to DisplayPort Multi-Monitor Splitter - 3-Port MST Hub		
REV: A	DO NOT SCALE	SHEET : 1 OF: 1	DATE: 07/15/2020