

WIRE CONNECTION:

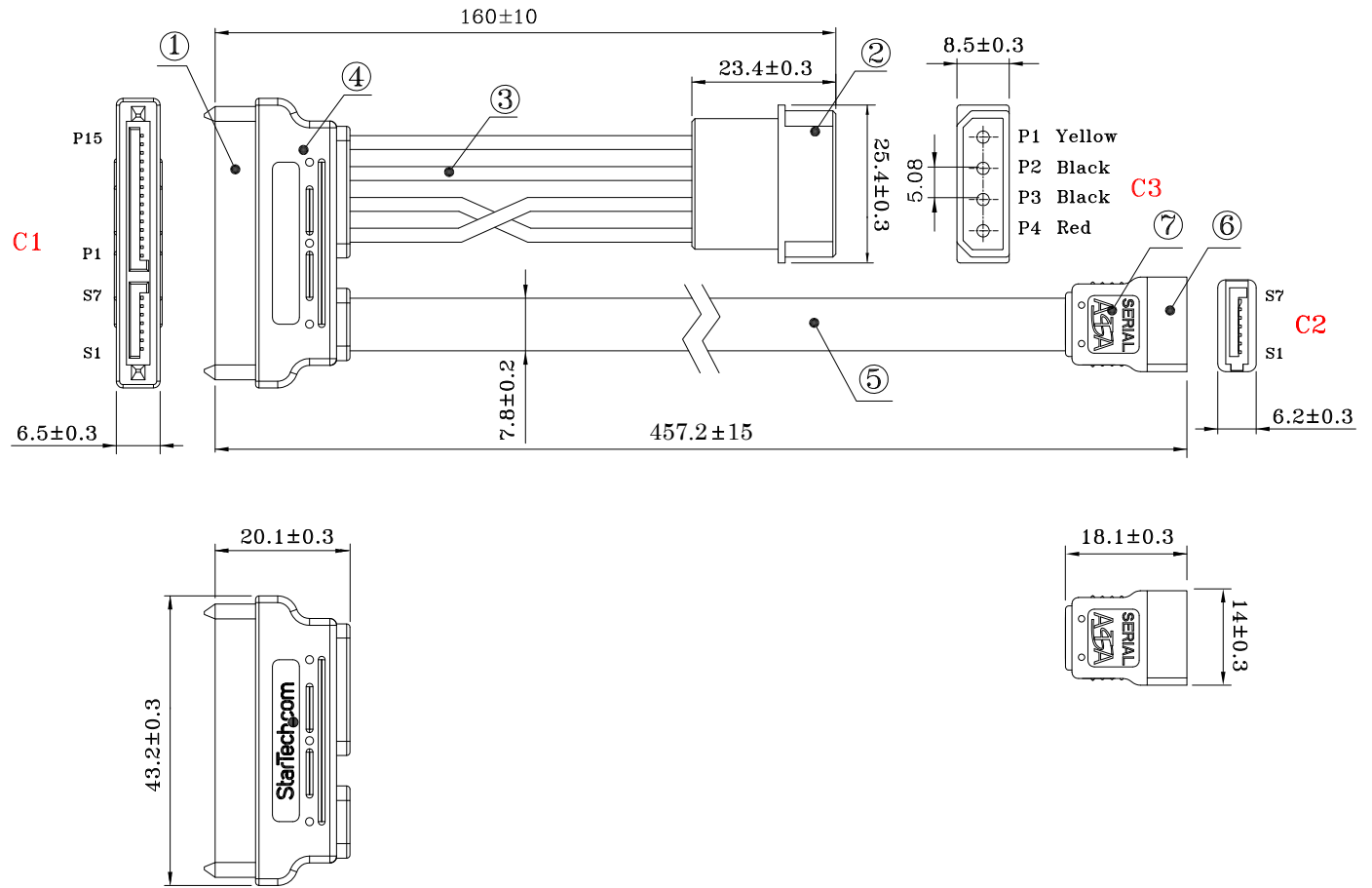
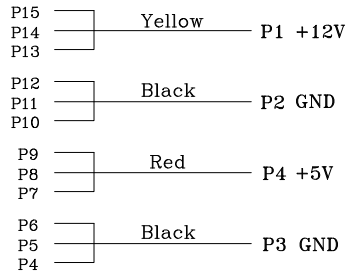
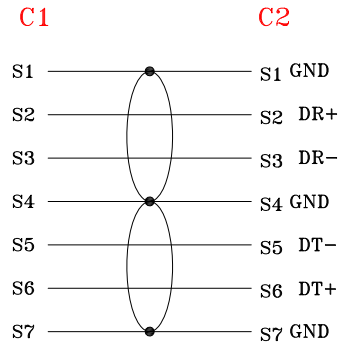

ROHS

- 100% OPEN / SHORT / INSULATING TEST
- INSULATION TEST: 2MΩ

COMPONENTS	DESCRIPTION	Q'TY
1	SA22F SATA 22P Female, Insulator: Black P.B.T UL94V-0 Contact: Copper Alloy 15u" And G/F Gold Plated	1
2	Housing 5.08mm 4P Male	1
3	Wire UL1007 18AWG OD:2.0mm (Color: Black X2, Yellow X1, Red X1)	4
4	HOOD PVC Molded Color: Black	1
5	CABLE Serial ATA Cable, UL2725, (26AWG*2C+HMAM+2D)*2PCS. Flat Cable, Red Color, 2.2*7.8, Insulator Material: FM-PE	1
6	SA07F Insulator: PBT UL94V-0,Black Contact: Phosphor Bronze 15u" Gold Plated	1
7	HOOD PVC 30P Molded Color: Black	1

THIRD ANGLE PROJECTION

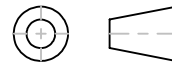

GENERAL NOTES

DIMENSIONS ARE IN MM - DO NOT SCALE
THIS DOCUMENT CONTAINS CONFIDENTIAL, PROPRIETARY INFORMATION THAT IS PROPERTY OF STARTECH.COM

StarTech.com

PRODUCT ID	SATA18POW
DESCRIPTION	18in SATA Serial ATA Data and Power Combo Cable
REV: A	DO NOT SCALE SHEET : 1 OF: 1 DATE: 07/02/2020